

Please consider registering online at:  
[www.bishopreedsportingclaychallenge.com](http://www.bishopreedsportingclaychallenge.com)

### Entry Form

Name \_\_\_\_\_

Sponsor Only  Men  Women  Senior  Junior

Phone \_\_\_\_\_

E-mail \_\_\_\_\_

Parish Affiliation \_\_\_\_\_

### Signing up a four man team

2. \_\_\_\_\_

Men  Women  Senior  Junior

3. \_\_\_\_\_

Men  Women  Senior  Junior

4. \_\_\_\_\_

Men  Women  Senior  Junior

### Select all that apply

	Totals
<input type="checkbox"/> Sponsorship Level (marked on back)	_____
<input type="checkbox"/> Men # _____ x \$200	_____
<input type="checkbox"/> Women # _____ x \$200	_____
<input type="checkbox"/> Senior (age 60+) # _____ x \$200	_____
<input type="checkbox"/> Junior (age 12-17) # _____ x \$150	_____

### Extras

- Drawing Tickets  
1 ticket-\$5 / 3 tickets-\$10 / 7 Tickets-\$20 \_\_\_\_\_
- Sponsor a Crucis Kid  
# of days \_\_\_\_\_ x \$10 \_\_\_\_\_

Check #: _____	Total: _____
----------------	--------------

### Please make checks payable to:

Episcopal Diocese of Fort Worth  
 Enter 'Sporting Clay' in the memo section of  
 the check. Staple check to Entry Form and  
 mail to: 2900 Alameda  
 Fort Worth, TX 76108

# The Bishop Reed Sporting Clay Challenge

## November 13, 2020

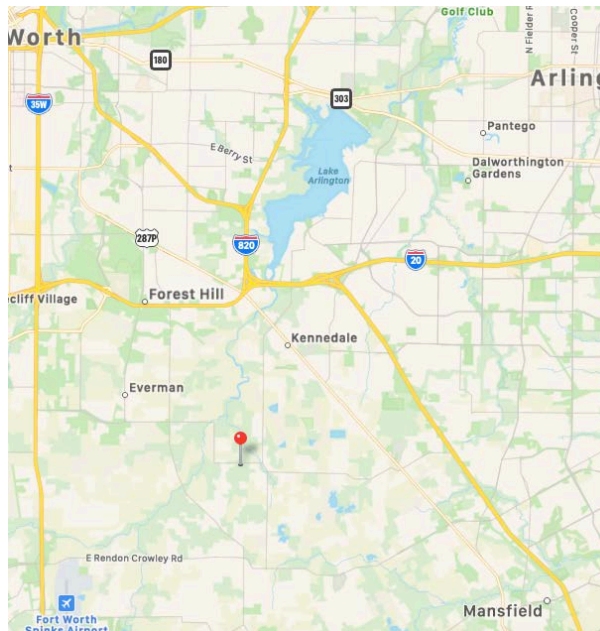

**Alpine Shooting Range**  
 5482 Shelby Road  
 Fort Worth, TX 76140  
 817-484-0775

Online tournament registrations available at:  
[www.bishopreedsportingclaychallenge.com](http://www.bishopreedsportingclaychallenge.com)

*Ensure your spot now  
 by registering before Oct 31*



# Sporting Clay Tournament

## November 13, 2020

**Benefiting Camp Crucis**

### ENTRY FORM

Online tournament registrations available at:  
[www.bishopreedsportingclaychallenge.com](http://www.bishopreedsportingclaychallenge.com)

*Ensure your spot now  
 by registering before Oct 31*

# Camp Crucis

Since 1947, Camp Crucis has been a ministry of the Episcopal Diocese of Fort Worth. The primary goal of Camp Crucis will always be to bring children to know and love Jesus Christ. Those who have experienced Crucis can attest to what a truly amazing place it is - and have seen the life-changing transformation of campers through The Holy Spirit and Christ's love for them first-hand.

By joining Bishop Reed for this great day of shooting, you will be part of bringing kids into the love of Jesus Christ.

Camp Crucis has been adversely impacted by the pandemic this year. Through your support, you will help offset some of the financial burden that we have faced since March and for the foreseeable future.

**See you at the range!**



*Bishop Reed personally invites you to accept "The Bishop Reed Challenge"*

**Place:** Alpine Shooting Range  
5482 Shelby Road  
Fort Worth, TX 76140  
Telephone: 817-484-0775

**Type:** 4-person team, true pair each station  
Shotgun Start at 9:30 am  
registration starts at 8:00 am

**Date:** November 13, 2020 (Friday)  
*Ensure your spot now by registering before Oct. 31st*

**All shooters will receive:**

- 100 shot shells, plus 1 extra box per team
- Golf cart for each team
- Safety glasses and ear protection
- Continental Breakfast and Lunch

**Contests after tourney:**

- Trap shoot elimination
- Skeet shoot challenge

Lunch, prize drawings, and awards presentation will follow immediately after competition. In the event of rain, the challenge will be rescheduled.

## Select your Sponsorship Level

- Major Title Sponsor** \$7,000
  - Includes two (4-person) teams
  - Business and Marketing opportunities
  - One night free lodging (64 persons) at Camp ^ for corporate meeting or day conference up to 200 persons
  - Company name displayed at tee stations #1 and #7
  - Company name on Sponsor Banner and Tournament Program
- Browning Sponsor** \$2,000
  - Includes one (4-person) team
  - Promotional items in Goodie Bag
  - One night free lodging (16 persons) at Camp Crucis for corporate meeting or day conference up to 200 persons
  - Company name displayed at stand #1
  - Company name on Sponsor Banner and Tournament Program
- Winchester Sponsor** \$1,000
  - Includes one (4-person) team
  - Promotional items in Goodie Bag
  - Stand Sponsor
  - Company name on Sponsor Banner and Tournament Program
- Remington Sponsor** \$600
  - Includes two players for play
  - Station sponsor
  - Company name on Sponsor Banner and Tournament Program
- Beretta Sponsor** \$300
  - Station sponsor.

Name of Sponsor \_\_\_\_\_

Sponsor Contact \_\_\_\_\_

Phone Number \_\_\_\_\_

*Please fill out entry form on the back*

*All donations are tax deductible*

*Thank you for your support of "The Bishop Reed Challenge"*