

Please consider registering online at:
www.bishopreedsportingclaychallenge.com

Entry Form

Name _____

Sponsor Only Men Women Senior Junior

Phone _____

E-mail _____

Parish Affiliation _____

Signing up a four man team

2. _____

Men Women Senior Junior

3. _____

Men Women Senior Junior

4. _____

Men Women Senior Junior

Select all that apply

- | | | |
|--|--------|-------|
| <input type="checkbox"/> Sponsorship Level (marked on back) | Totals | _____ |
| <input type="checkbox"/> Men # _____ x \$220 | | _____ |
| <input type="checkbox"/> Women # _____ x \$220 | | _____ |
| <input type="checkbox"/> Senior (age 60+) # _____ x \$220 | | _____ |
| <input type="checkbox"/> First Responder/ Military # _____ x \$195 | | _____ |
| <input type="checkbox"/> Junior (age 12-17) # _____ x \$170 | | _____ |

Extras

- Drawing Tickets
1 ticket-\$5 / 3 tickets-\$10 / 7 Tickets-\$20 _____
- Sponsor a Crucis Kid
of days _____ x \$10 _____

Check #: _____ Total: _____

Please make checks payable to:

Episcopal Diocese of Fort Worth
Enter 'Sporting Clay' in the memo section of
the check. Staple check to Entry Form and
mail to: 2900 Alameda
Fort Worth, TX 76108

The Bishop Reed Sporting Clay Challenge

September 28, 2024

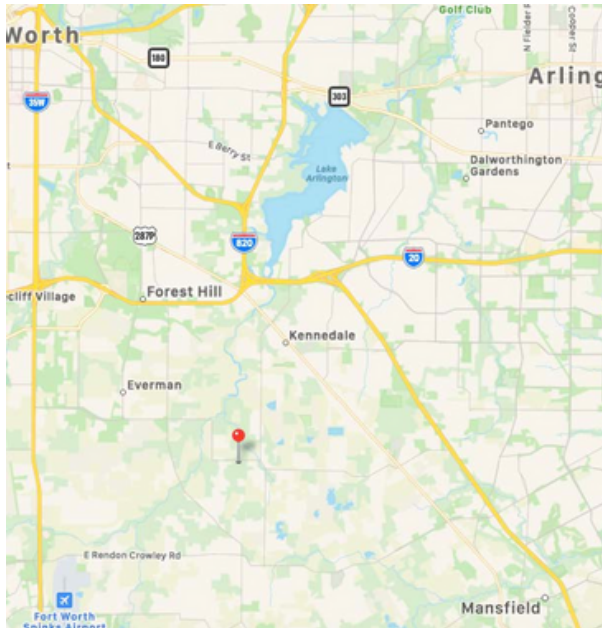

Alpine Shooting Range

5482 Shelby Road

Fort Worth, TX 76140

817-484-0775

Online tournament registrations available at:
www.bishopreedsportingclaychallenge.com

Ensure your spot now
by registering before September 8



Sporting Clay Tournament

September 28, 2024

Benefiting Camp Crucis

ENTRY FORM

Online tournament registrations available at:
www.bishopreedsportingclaychallenge.com

Ensure your spot now
by registering before September 20

Camp Crucis

Since 1947, Camp Crucis has been a ministry of the Episcopal Diocese of Fort Worth. The primary goal of Camp Crucis will always be to bring children to know and love Jesus Christ. Those who have experienced Crucis can attest to what a truly amazing place it is - and have seen the life-changing transformation of campers through The Holy Spirit and Christ's love for them first-hand.

By joining Bishop Reed for this great day of shooting, you will be part of bringing kids into the love of Jesus Christ.

See you at the range!



Bishop Reed personally invites you to accept "The Bishop Reed Challenge"

Place: Alpine Shooting Range
5482 Shelby Road
Fort Worth, TX 76140
Telephone: 817-484-0775

Type: 4-person team, true pair each station
Shotgun Start at 9:30 am
registration starts at 8:00 am

Date: September 28, 2024 (Saturday)
Ensure your spot now by registering before Sept. 20

All shooters will receive:

- 100 shot shells, plus 1 extra box per team
- Golf cart for each team
- Safety glasses and ear protection
- Continental Breakfast and Lunch

Lunch, prize drawings, and awards presentation will follow immediately after competition. In the event of rain, the challenge will be rescheduled.

Select your Sponsorship Level

Major Title Sponsor \$7,000

- Includes two (4-person) teams
- Business and Marketing opportunities
Company name displayed at tee stations #1 and #7
Company name on Sponsor Banner and Tournament Program

Browning Sponsor \$2,400

- Includes one (4-person) team
- Promotional items in Goodie Bag
Company name displayed at stand #1
- Company name on Sponsor Banner and Tournament Program

Winchester Sponsor \$1,200

- Includes one (4-person) team
- Promotional items in Goodie Bag
- Stand Sponsor
- Company name on Sponsor Banner and Tournament Program

Remington Sponsor \$800

- Includes two players for play
- Station sponsor
- Company name on Sponsor Banner and Tournament Program

Beretta Sponsor \$300

- Station sponsor.

Name of Sponsor _____

Sponsor Contact _____

Phone Number _____

*Please fill out entry form on the back
All donations are tax deductible*

*Thank you for your support of
"The Bishop Reed Challenge"*